

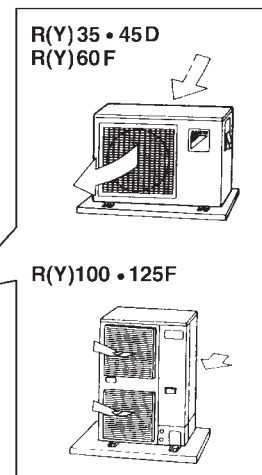

OPERATION MANUAL

Split System air conditioners

FHC35FJ7V1	FHYC35FJ7V1
FHC45FJ7V1	FHYC45FJ7V1
FHC60FJ7V1	FHYC60FJ7V1
	FHYC71FJ7V1
	FHYC100FJ7V1
	FHYC125FJ7V1

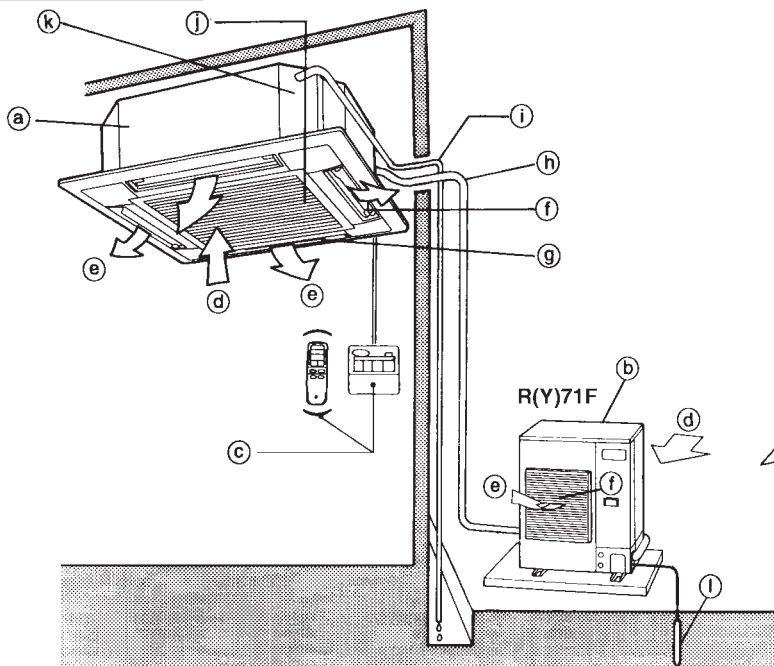
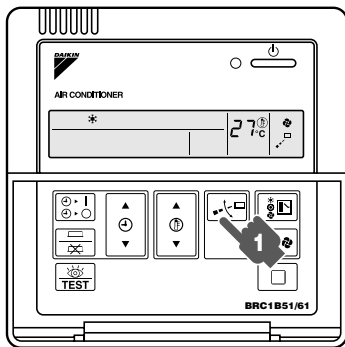
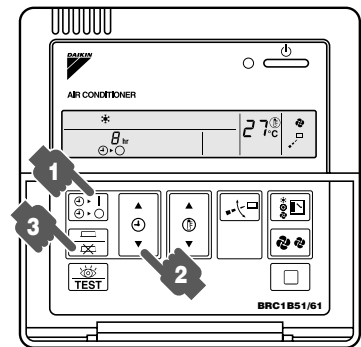
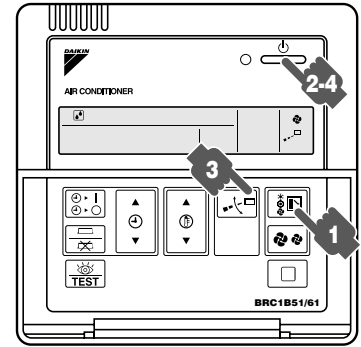
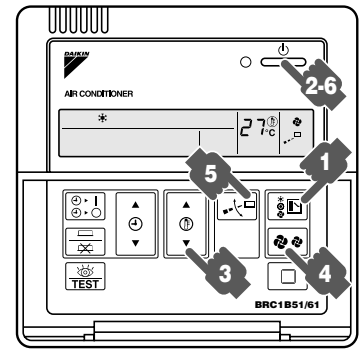
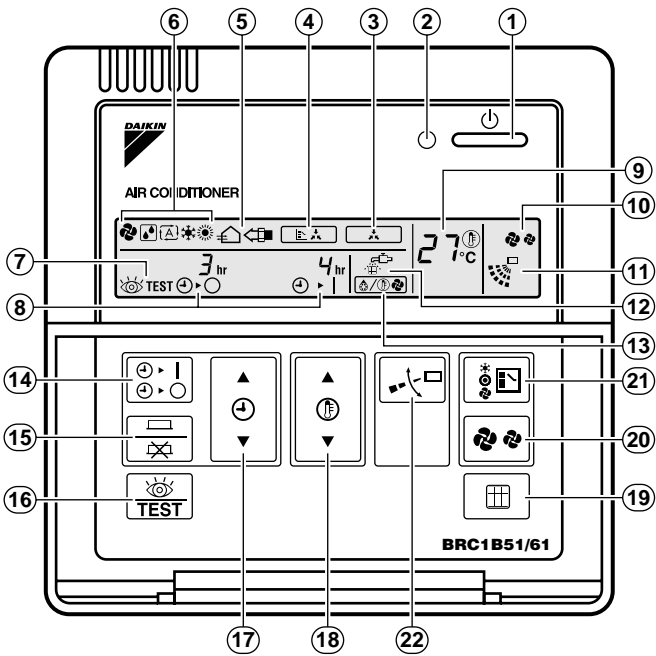

Names and functions of parts
 Bezeichnung und Funktion der Teile
 Nom et fonction des pièces
 Namen en funcities van onderdelen

Nombres y funciones de las partes
 Nomi e funzioni delle parti
 Ονομασίες και λειτουργίες εξαρτημάτων
 Nomes e funcões das peças

Delenes navne og funktioner
 Komponenternas benämning och funktioner
 Navn på deler og deres funksjoner
 Osien nimet ja toiminnot

	page
What to do before operation	1
Name and function of each switch and display on the remote controller	1
Warning	2
Operation range	2
Installation site	2
Operation procedure	2
Optimum operation	4
Not malfunction of the air conditioner	4
Trouble shooting	5
Maintenance	6



THANK YOU FOR PURCHASING THIS DAIKIN AIR CONDITIONER. CAREFULLY READ THIS OPERATION MANUAL BEFORE USING THE AIR CONDITIONER. IT WILL TELL YOU HOW TO USE THE UNIT PROPERLY AND HELP YOU IF ANY TROUBLE OCCURS. AFTER READING THE MANUAL, FILE IT AWAY FOR FUTURE REFERENCE.

WHAT TO DO BEFORE OPERATION

This operation manual is for the following systems with standard control. Before initiating operation, contact your Daikin dealer for the operation that corresponds to your system.

If your installation has a customized control system, ask your Daikin dealer for the operation that corresponds to your system.

- Heat pump type
This system provides cooling, heating, automatic, program dry, and fan operation modes.
- Straight cooling type
This system provides cooling, program dry, and fan operation modes.

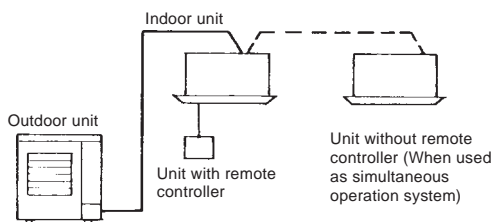

NOTE: If the unit you purchased is controlled by a wireless remote controller, also refer to the wireless remote controller's operation manual.

Names and functions of parts (Fig. 6)

- a Indoor unit
- b Outdoor unit
- c Remote controller
- d Inlet air
- e Discharged air
- f Air outlet
- g Air flow flap (at air outlet)
- h Refrigerant piping, connection electric wire

- i Drain pipe
- j Air inlet
The built-in air filter removes dust and dirt.
- k Drain pumping out device (built-in)
Drains water removed from the room during cooling.
- l Ground wire
Wire to ground from the outdoor unit to prevent electrical shocks.

NAME AND FUNCTION OF EACH SWITCH AND DISPLAY ON THE REMOTE CONTROLLER (FIG. 1)

- 1 ON/OFF BUTTON
Press the button and the system will start. Press the button again and the system will stop.
- 2 OPERATION LAMP (RED)
The lamp lights up during operation.
- 3 DISPLAY “” (CHANGEOVER UNDER CONTROL)
This display shows when the outdoor unit is individual operation system.
- 5 DISPLAY “” “” “” (Auto) and “” (INSPECTION/TEST OPERATION)
When the INSPECTION/TEST OPERATION BUTTON is pressed, the display shows the system mode is in.
- 8 DISPLAY “” (SET TEMPERATURE)
This display shows the set temperature.
- 10 DISPLAY “” (AIR FLOW FLAP)
Refer to page 3.
- 12 DISPLAY “” (DEFROST)
Refer to page 5.
- 14 TIMER MODE START/STOP BUTTON
Refer to page 4.
- 15 TIMER ON/OFF BUTTON
Refer to page 4.
- 16 INSPECTION/TEST OPERATION BUTTON
This button is used only by qualified service persons for maintenance purposes.

17 PROGRAMMING TIME BUTTON

Use this button for programming "START and/or STOP" time.

18 TEMPERATURE SETTING BUTTON

Use this button for SETTING TEMPERATURE.

19 FILTER SIGN RESET BUTTON

Refer to page 6.

20 FAN SPEED CONTROL BUTTON

Press this button to select the fan speed, HIGH or LOW, of your choice.

21 OPERATION MODE SELECTOR BUTTON

Press this button to select OPERATION MODE.

22 AIR FLOW DIRECTION ADJUST BUTTON

Refer to page 3.

NOTE: For the sake of explanation, all indications are shown on the display in Figure 1 contrary to actual running situations.

WARNING

NEVER DO THE FOLLOWING

- Never let the indoor unit and the remote controller get wet. It may cause an electric shock or a fire.
- Never use flammable spray such as hair spray, lacquer or paint near the unit. It may cause a fire.
- Never touch the air outlet or the horizontal blades while the swing flap is in operation. Fingers may become caught or the unit may break down.
- Never replace a fuse with that of a wrong ampere rating or other wires when the fuse blows out. Use of wire or copper wire may cause the unit to break down or cause a fire.
- Never put anything as sticks into the air inlet and outlet. If an object touches the fan operating at high speed, it is dangerous.
- Never remove the fan guard of the outdoor unit. The rotating fan at high speed without the guard is very dangerous.
- Never press the button of the remote controller with a hard, pointed object. The remote controller may be damaged.
- Never pull or twist the electric wire of a remote controller. It may cause the unit to malfunction.
- Never inspect or service the unit by yourself. Ask a qualified service person to perform this work.

OPERATION RANGE

If the temperature or the humidity is beyond the following conditions, safety devices may work and the air conditioner may not operate, or sometimes, water may drop from the indoor unit.

COOLING

[°C]

	OUTDOOR UNIT	INDOOR		OUTDOOR TEMPERATURE		
		TEMPERATURE	HUMIDITY			
STRAIGHT COOLING TYPE	R35 • 45 • 60	D B	18–33	80%	D B	-15–46 (R35 • 45C) 19,4–46
		W B	12–24			
	R71 • 100 • 125	D B	18–35		D B	-15–46
		W B	12–25			
HEAT PUMP TYPE	RY35 • 45 • 60	D B	18–35	80%	D B	-5–46
		W B	12–25			
	RY71 • 100 • 125	D B	18–35		D B	-5–46
		W B	12–25			

HEATING

[°C]

	OUTDOOR UNIT	INDOOR TEMPERATURE		OUTDOOR TEMPERATURE	
HEAT PUMP TYPE	RY35 • 45 • 60	D B	15–27	D B	-9–21
				W B	-10–15,5
	RY71 • 100 • 125	D B	15–24	D B	-9–21
				W B	-10–15,5

DB: Dry bulb temperature

WB: Wet bulb temperature

The setting temperature range of the remote controller is 16°C–32°C.

INSTALLATION SITE

CONFIRM THE FOLLOWING





- Never place anything under the indoor unit that is distressed when soaked in water. Water may drop when the humidity is over 80% or when the drain outlet is clogged.
- Never place other heating equipment under the indoor unit. It may cause deformation due to heat.
- Place TV, radio, stereo, etc. at least 1 meter away from the indoor unit and remote controller. It may cause interference in the picture or sound.

OPERATION PROCEDURE

- Operating procedure varies with heat pump type and straight cooling type. Contact your Daikin dealer to confirm your system type.
- To protect the unit, turn on the main power switch 6 hours before operation.
- If the main power supply is turned off during operation, operation will restart automatically after the power turns back on again.

COOLING, HEATING, AUTOMATIC, AND FAN OPERATION (Fig. 2)

1 Press OPERATION MODE SELECTOR button several times and select the OPERATION MODE of your choice as follows.

- COOLING OPERATION 
- HEATING OPERATION 
- AUTOMATIC OPERATION [A] 
- FAN OPERATION 

• For straight cooling type, “cooling” and “fan” operation are able to select.

AUTOMATIC OPERATION

In this operation mode, COOL/HEAT changeover is automatically conducted.

2 Press ON/OFF button.
OPERATION lamp light up and the system starts OPERATION.

Adjustment

For programming TEMPERATURE, FAN SPEED and AIR FLOW DIRECTION, follow the procedure shown below.

3 Press TEMPERATURE SETTING button and program the setting temperature.

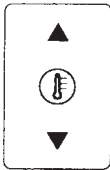

- Each time this button is pressed, setting temperature rises 1°C.
- Each time this button is pressed, setting temperature lowers 1°C.

• The setting is impossible for fan operation.

NOTE: Set the temperature within the OPERATION RANGE on p. 2.

4 Press FAN SPEED CONTROL button.
High or Low fan speed can be selected.

5 Press AIR FLOW DIRECTION button
Refer to “ADJUSTING THE AIR FLOW DIRECTION” for details.

STOPPING THE SYSTEM

6 Press ON/OFF button once again.
OPERATION lamp goes off, and the system stops OPERATION.

EXPLANATION OF HEATING OPERATION

DEFROST OPERATION

- As the frost on the coil of an outdoor unit increase, heating effect decreases and the system goes into DEFROST OPERATION.
- The indoor unit fan stops and the remote controller display show “”.
- After 6 to 8 minutes (maximum 10 minutes) of DEFROST OPERATION, the system returns to HEATING OPERATION.

PROGRAM DRY OPERATION (Fig. 3)

- The function of this program is to decrease the humidity in your room with the minimum temperature decrease.
- Micro computer automatically determines TEMPERATURE and FAN SPEED.
- This system does not go into operation if the room temperature is below 16°C.

1 Press OPERATION MODE SELECTOR button several times and select “” (PROGRAM DRY OPERATION).

2 Press ON/OFF button.
OPERATION lamp lights up and the system starts OPERATION.

Adjustment

3 Press AIR FLOW DIRECTION ADJUST button.
Refer to “ADJUSTING THE AIR FLOW DIRECTION” for details.

STOPPING THE SYSTEM

4 Press ON/OFF button again.
OPERATION lamp goes off and the system stops OPERATION.

ADJUSTING THE AIR FLOW DIRECTION (Fig. 4)

Press the AIR FLOW DIRECTION button to adjust the air flow angle.

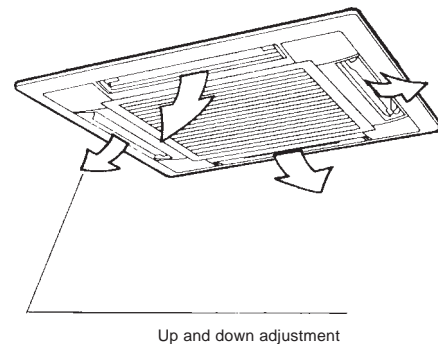

Up and down adjustment

- The movable limit of the blade is changeable. Contact your Daikin dealer for details.

1 Press the AIR FLOW DIRECTION ADJUST button to select the air direction as shown below.

The AIR FLOW FLAP display swings as shown below and the air flow direction continuously varies. (Automatic swing setting)



Press AIR FLOW DIRECTION ADJUST button to select the air direction of your choice.



The AIR FLOW FLAP display stops swinging and the air flow direction is fixed. (Fixed air flow direction setting)



MOVEMENT OF THE AIR FLOW FLAP

For the following conditions, micro computer controls the air flow direction so it may be different from the display.

Operation mode	Cooling	Heating
Operation conditions	<ul style="list-style-type: none"> When room temperature is lower than the set temperature 	<ul style="list-style-type: none"> When room temperature is higher than the set temperature At defrost operation
	<ul style="list-style-type: none"> When operating continuously at horizontal air flow direction 	

Operation mode includes automatic operation.

PROGRAM TIMER OPERATION (Fig. 5)

- The timer is operated in the following two ways. Programming the stop time ("⏸") ... The system stops operating after the set time has elapsed. Programming the start time ("⏹") ... The system starts operating after the set time has elapsed.
- The timer can be programmed a maximum of 72 hours.
- The start and the stop time can be simultaneously programmed.

1 Press the TIMER MODE START/STOP button several times and select the mode on the display. The display flashes.

For setting the timer stop ... "⏸".

For setting the timer start ... "⏹".

2 Press the PROGRAMMING TIME button and set the time for stopping or starting the system.

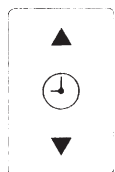

When this button is pressed, the time advances by 1 hour.

When this button is pressed, the time goes backward by 1 hour.

3 Press the TIMER ON/OFF button.

The timer setting procedure ends.

The display "⏸" or "⏹" changes from flashing light to a constant light.

NOTE:

- When setting the timer Off and On at the same time, repeat the above procedure from 1. to 3. once again.

For example:

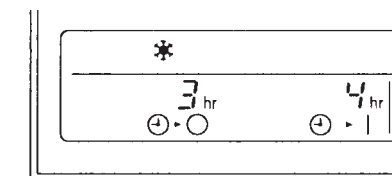

When the timer is programmed to stop the system after 3 hours and start the system after 4 hours, the system will stop after 3 hours and then 1 hour later the system will start.

- After the timer is programmed, the display shows the remaining time.
- Press the TIMER ON/OFF button once again to cancel programming. The display vanishes.

PRECAUTIONS FOR GROUP CONTROL SYSTEM OR TWO REMOTE CONTROLLER CONTROL SYSTEM

This system provides two other control systems beside individual control (one remote controller controls one indoor unit) system. Confirm the following if your unit is of the following control system type.

- Group control system
One remote controller controls up to 16 indoor units. All indoor units are equally set.
- Two remote controller control system
Two remote controllers control one indoor unit (In case of group control system, one group of indoor units). The unit is individually operated.

NOTE: Contact your Daikin dealer in case of changing the combination or setting of group control and two remote controller control systems.

OPTIMUM OPERATION

Observe the following precautions to ensure the system operates properly.

- Adjust the air outlet properly and avoid direct air flow to room inhabitants.
- Adjust the room temperature properly for a comfortable environment. Avoid excessive heating or cooling.
- Prevent direct sunlight from entering a room during cooling operation by using curtains or blinds.
- Keep doors and windows closed. If the doors and windows remain open, room air will flow out and cause to decrease the effect of cooling and heating.
- Never place objects near the air inlet and the air outlet of the unit. It may cause deterioration in the effect or stop in the operation.
- Turn off the main power supply switch when it is not used for long periods of time. If the switch is on, it uses electricity. Turn off the main power supply switch for saving energy. When reoperating, turn on the main power supply switch 6 hours before operation for smooth running. (Refer to p. 6 for MAINTENANCE)
- When the display shows "⏸" TIME TO CLEAN AIR FILTER, ask a qualified service person to clean the filters. (Refer to p. 6 for MAINTENANCE)

NOT MALFUNCTION OF THE AIR CONDITIONER

The following symptoms do not indicate air conditioner malfunction.

1. THE SYSTEM DOES NOT OPERATE

- The system does not restart immediately after the ON/OFF button is pressed.
If the OPERATION lamp lights, the system is in normal condition.
It does not restart immediately because a safety device operates to prevent overload of the system. After 3 minutes, the system will turn on again automatically.
- The system does not restart immediately when the TEMPERATURE SETTING button is returned to the former position after pushing the button.
It does not restart immediately because a safety device operates to prevent overload of the system. After 3 minutes, the system will turn on again automatically.

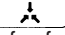
- The system does not start when the display shows “” (UNDER CENTRALIZED CONTROL) and it flashes for few seconds after pressing an operation button. This is because the system is under centralized control. Flashes on the display indicates that the system cannot be controlled by the remote controller.
- The system does not start immediately after the power supply is turned on. Wait one minute until the micro computer is prepared for operation.

II. WHITE MIST COMES OUT OF A UNIT

- When humidity is high during cooling operation (In oily or dusty places)
If the inside of an indoor unit is extremely contaminated, the temperature distribution inside a room becomes uneven. It is necessary to clean the inside of the indoor unit. Ask your Daikin dealer for details on cleaning the unit. This operation requires a qualified service person.
- When the system is changed over to HEATING OPERATION after DEFROST OPERATION.
Moisture generated by DEFROST becomes steam and exits.

III. NOISE OF AIR CONDITIONERS

- A continuous low “Shuh” sound is heard when the system is in COOLING or DEFROST OPERATION.
This is the sound of refrigerant gas flowing through both indoor and outdoor units.
- A “Shuh” sound which is heard at the start or immediately after the stop of operation or which is heard at the start or immediately after the stop of DEFROST OPERATION.
This is the noise of refrigerant caused by flow stop and flow change.
- A continuous low “Shah” sound is heard when the system is in COOLING OPERATION or at a stop
The noise is heard when the drain pump is in operation.
- A “Pishi-pishi” squeaking sound is heard when the system is in operation or after the stop of operation.
Expansion and contraction of plastic parts caused by temperature change makes this noise.

IV. DUST FROM THE UNITS

- Dust may blow out from the unit after starting operation from long resting time.
Dust absorbed by the unit blows out.

V. THE UNITS GIVE OFF ODORS

- The unit absorbs the smell of rooms, furniture, cigarettes, etc., and then emits them.

VI. THE LIQUID CRYSTAL OF THE REMOTE CONTROLLER SHOW “88”

- It happens immediately after the main power supply switch is turned on.
This shows that the remote controller is in normal condition. This continues temporary.

TROUBLE SHOOTING

I. If one of the following malfunctions occurs, take the measures shown below and contact your Daikin dealer.

The system must be repaired by a qualified service person.

- If a safety device such as a fuse, a breaker, or an earth leakage breaker frequently actuates, or ON/OFF switch does not properly work.
Measure: Turn off the main power switch
- If water leaks from unit.
Measure: Stop the operation.
- If the display “” (INSPECTION), “UNIT No.”, and the OPERATION lamp flash and the “MALFUNCTION CODE” appears.

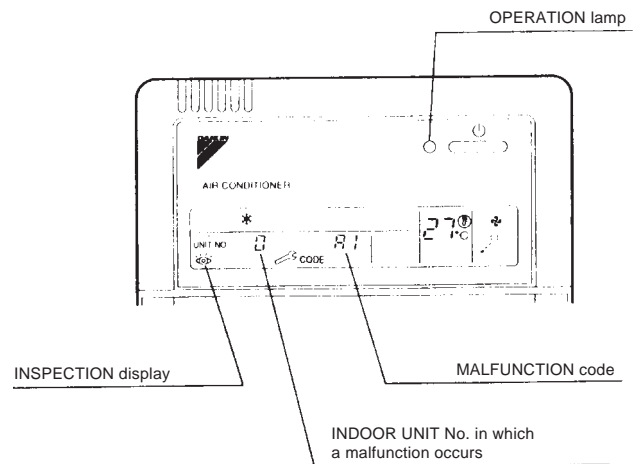

Measure: notify your Daikin dealer and inform hem/her of the display.

II. If the system does not properly operate except for the above mentioned case, and none of the above mentioned malfunctions is evident, investigate the system according to the following procedures.

- 1) If the system does not operate at all.
 - Check if there is a power failure.
Wait until power is restored. If power failure occurs during operation, the system automatically restarts immediately after the power supply recovers.
 - Check if the fuse has blown or breaker has worked.
Change the fuse or set the breaker.
- 2) If the system stops operating after operating the system.
 - Check if the air inlet or outlet of outdoor or indoor unit is blocked by obstacles.
Remove the obstacle and make it wellventilated.
 - Check if the air filter is clogged.
Ask a qualified service person to clean the air filter. (Refer to p. 6)
- 3) The system operates but it does not sufficiently cool or heat.
 - If the air inlet or outlet of the indoor or the outdoor unit is blocked with obstacles.
Remove the obstacle and make it wellventilated.
 - If the air filter is clogged.
Ask a qualified service person to clean the air filter. (Refer to p. 6)
 - If the set temperature is not proper. (Refer to p. 3)
 - If the FAN SPEED button is set to LOW SPEED. (Refer to p. 3)
 - If the air flow angle is not proper. (Refer to p. 3)

- If the doors or the windows are open. Shut doors or windows to prevent wind from coming in.
- If direct sunlight enters the room (when cooling). Use curtains or blinds.
- When there are too many inhabitants in the room. Cooling effect decreases if heat gain of the room is too large.
- If the heat source of the room is excessive (when cooling). Cooling effect decreases if heat gain of the room is too large.

MAINTENANCE

IMPORTANT!

- ONLY A QUALIFIED SERVICE PERSON IS ALLOWED TO PERFORM MAINTENANCE.
- BEFORE OBTAINING ACCESS TO TERMINAL DEVICES, ALL POWER SUPPLY CIRCUITS MUST BE INTERRUPTED.
- DO NOT USE WATER OR AIR OF 50°C OR HIGHER FOR CLEANING AIR FILTERS AND OUTSIDE PANELS.

HOW TO CLEAN THE AIR FILTER

Clean the air filter when the display shows “” (TIME TO CLEAN AIR FILTER).

Increase the frequency of cleaning if the unit is installed in a room where the air is extremely contaminated.

If the dirt becomes impossible to clean, change the air filter. (Air filter for exchange is optional.)

1. Open the suction grille.
Slide both knobs simultaneously as shown and then pull them downward.
(Do the same procedure for closing.)

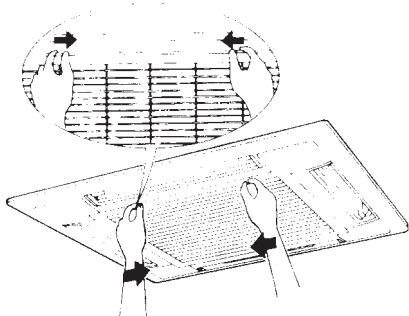

2. Remove the air filters
Slide knobs on the back of the suction grille outward and remove the air filter.

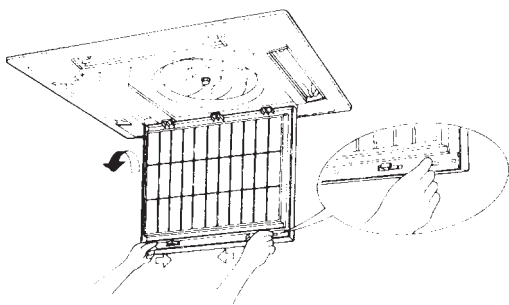

3. Clean the air filter.
Use vacuum cleaner (A) or wash the air filter with water (B).

(A)Using a vacuum cleaner

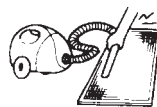

(B)Washing with water



When the air filter is very dirty, use soft brush and neutral detergent.

Remove water and dry in the shade.

4. Fix the air filter.
 - 1 Fix air filter to the suction grille by hanging it to the projected portion above suction grille.
 - 2 Set air filter by sliding the knob on the back of the suction grille inward.

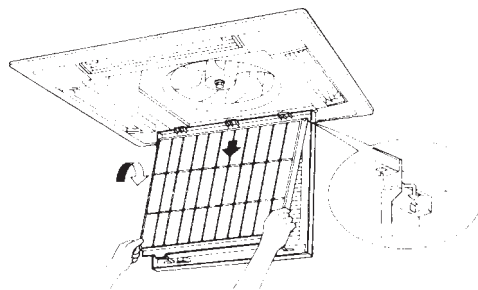

5. Shut the air inlet grille.
Refer to item No. 1.
6. After turning on the power, press FILTER SIGN RESET button.
The “TIME TO CLEAN AIR FILTER” display vanishes.

HOW TO CLEAN AIR OUTLET AND OUTSIDE PANELS

- Clean with soft cloth.
- When it is difficult to remove stains, use water or neutral detergent.
- When the blade is extremely contaminated, remove it as below and clean or exchange it.
(Blade for exchange is optional.)

NOTE:

- Do not use gasoline, benzene, thinner, polishing powder, liquid insecticide. It may cause discoloring or warping.
- Do not let the indoor unit get wet. It may cause an electric shock or a fire.
- Do not scrub firmly when washing the blade with water. The surface sealing may peel off.

HOW TO DETACH THE AIR FLOW FLAP

Contact your Daikin dealer for details.

1. Adjust the air flow direction to the lowest point.
(Refer to p. 3)
2. Detach the flap.
Loosen the screws on the sides of the flap.

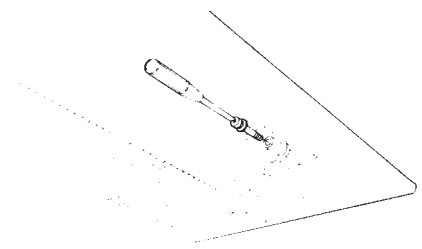

3. Fix the flap.
Set the ribs on the sides of the air outlet to the slit of the flap.
Then, screw together to fix the flap.

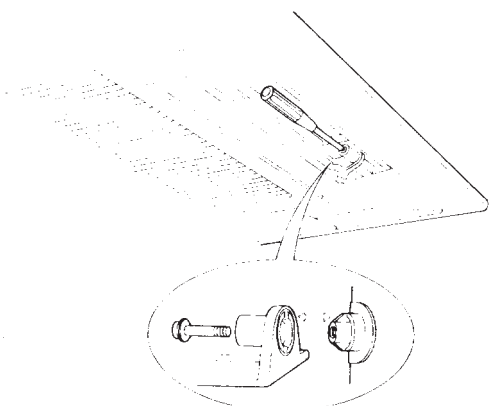

HOW TO CLEAN THE SUCTION GRILLE

1. Open the suction grille.
Slide both knobs and then pull them downward.
(Do the same procedure for closing.)

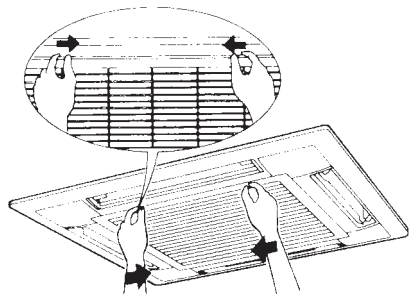

2. Detach the suction grille.
Open the suction grille 45 degrees and lift it upward.

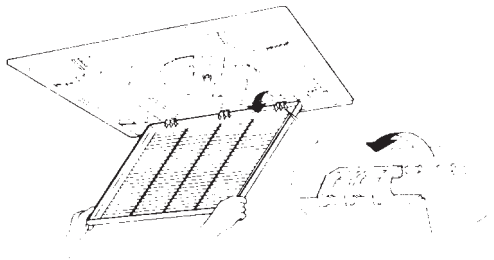

3. Detach the air filter.
Refer to p. 6, "HOW TO CLEAN THE AIR FILTER".
4. Clean the suction grille.
Wash with a soft bristle brush and neutral detergent or water, and dry thoroughly.
5. Reattach the air filter.
Refer to "HOW TO CLEAN THE AIR FILTER (p. 6)".
6. Reattach the suction grille.
Refer to item No. 2.
7. Close the suction grille.
Refer to item No. 1.



START UP AFTER A LONG STOP

- Confirm the following:
- Check that the air inlet and outlet are not blocked. Remove any obstacle.
 - Check if the earth is connected.

Clean the air filter and outside panels.

- After cleaning the air filter, make sure to attach it.

- Turn on the main power supply switch.
- The display on the remote controller will be shown when the power is turned on.
 - To protect the unit, turn on the main power switch at least 6 hours before operation.

WHAT TO DO WHEN STOPPING THE SYSTEM FOR A LONG PERIOD

- Turn on FAN OPERATION for a half day and dry the unit.
- Refer to page 3 for "FAN OPERATION".

- Cut off the power supply.
- When the main power switch is turned on, some watts of electricity is being used even if the system is not operating.
 - The display on the remote controller will vanish when the main power switch is turned off.

DISPOSAL REQUIREMENTS

Dismantling of the unit, treatment of the refrigerant, oil and eventual other parts, should be done in accordance with the relevant local and national regulations.

DAIKIN EUROPE NV

Zandvoordestraat 300, B-8400 Oostende, Belgium

4PWE03927-1C